

**FROM THE ROOTS OF A TREE:
THE GENEALOGY OF MARTIN LUTHER KING, JR.**

National Archives at Atlanta

Family Tree for Martin Luther King, Jr.

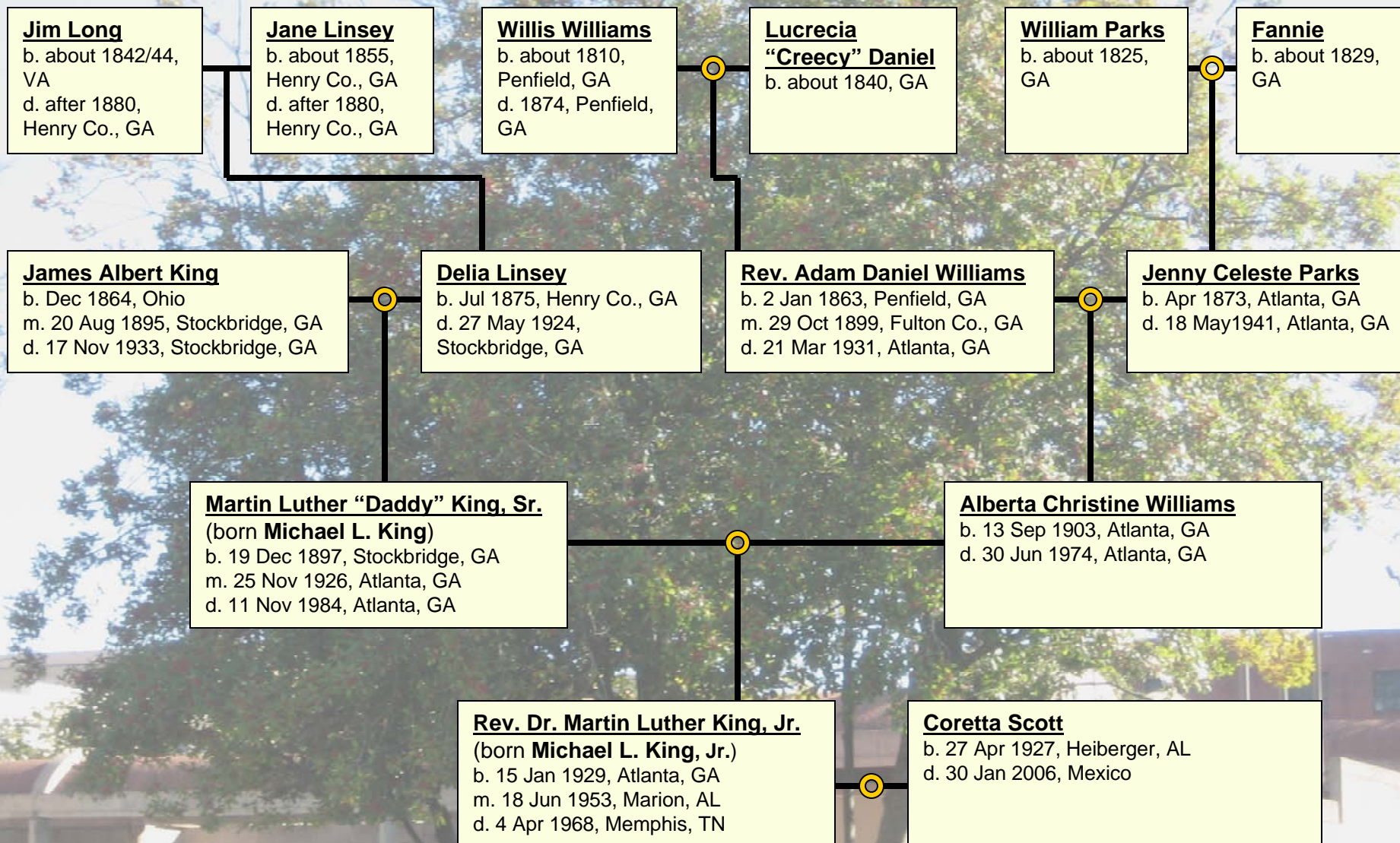

The Williams Family

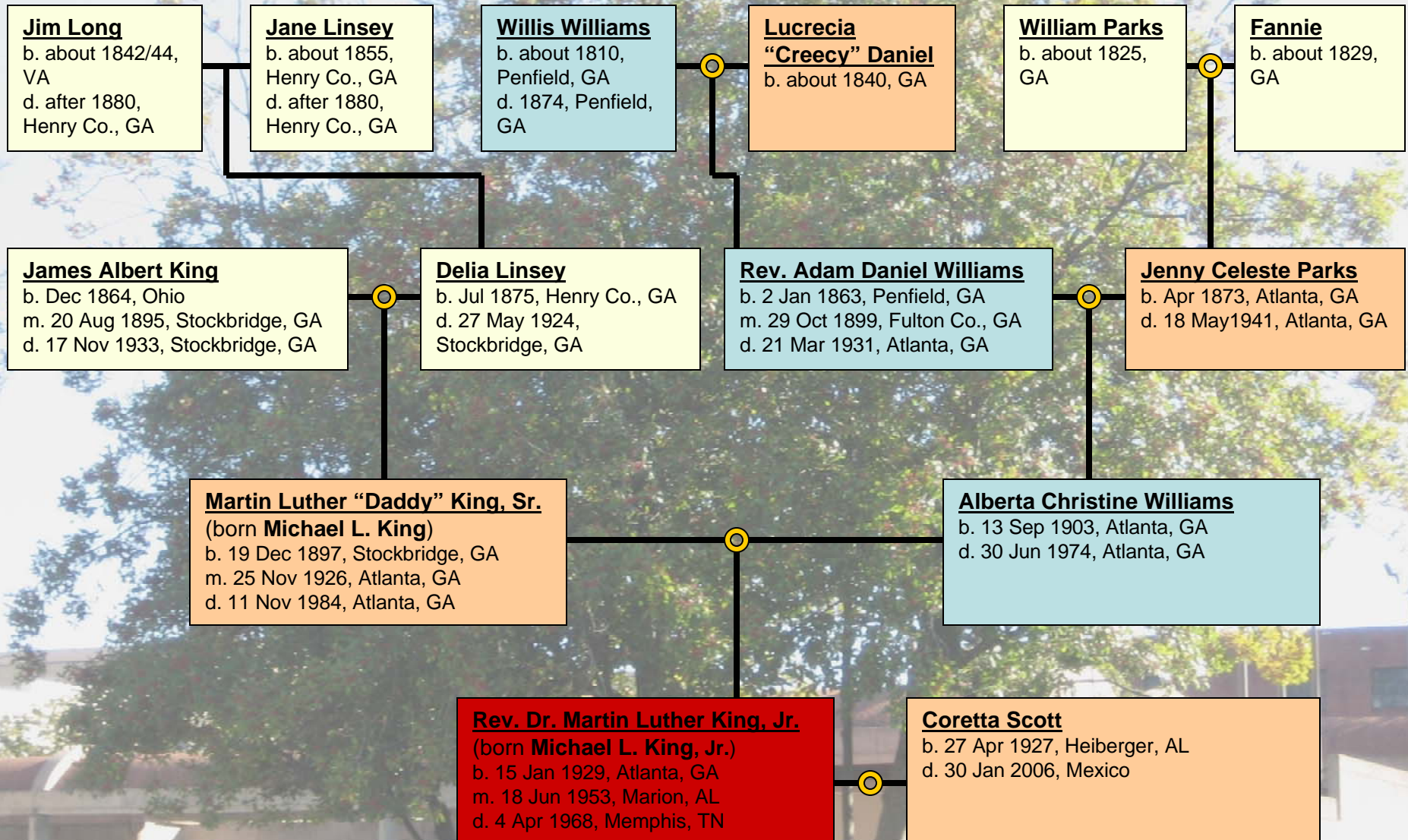

Penfield, Greene County, Georgia

The slave owner of Willis Williams, William Nelson Williams, was enumerated on the 1860 census living in Penfield, Greene County, Georgia. William, his family, and slaves lived on the Williams Plantation in Penfield.

37	77	78	Wm C. Williams	62	M	Farmers	✓
38			Stanley	63	F		
39			Wm S	16	M		
40			Mary E McWhorter	210	F		

Greene County, Georgia

Martin Luther King, Jr.'s Great-Grandfather, Willis Williams, was enumerated on the 1860 Census as a slave of William Nelson Williams in Greene County, Georgia. The slave schedules did not name individual slaves, but listed the age and gender. Willis Williams is shown as fifty-five years old at the time of this census.

31	<i>Wm A Williams</i>	1	60	M	4
32		1	60	F	4
33		1	55	M	4
34		1	50	F	4

Willis Williams

- **Slave on Williams Plantation in Penfield, Greene County, Georgia**
- **He was a minister**
- **Willis, his wife, Creecy, and the family of William Nelson, all attended Shiloh Baptist Church in Penfield before the Civil War; Shiloh Baptist considered both slaves and whites as members of their church**
- **After the abolition of slavery, the Williams family stayed in Greene County farming, until the death of Willis Williams in 1874**

1870 Census

District 140 (Penfield), Greene County, Georgia

Martin Luther King, Jr.'s Great-Grandparents, Willis and Creecy Williams, were farmers in Penfield, GA in 1870 and their five children lived with them.

[illegible]

Rev. Adam Daniel (A.D.) Williams

- Son of Willis and Creecy Williams, and Grandfather of Martin Luther King, Jr.
- A.D. and his mother left the Williams Plantation after his father's death in 1874
- He attended Atlanta Baptist College (later named Morehouse College) and graduated in May 1898
- He was the second pastor of Ebenezer Baptist Church in Atlanta
- A.D. Williams was the organizer and 1st President of the Atlanta Chapter of the NAACP



Skull Shoals, Greene County, Georgia

Page No. 7

Superior's Dist. No. 1
Enumeration Dist. No. 19

State of Georgia Census Year June 1, 1880, and May 31, 1880.

State of Georgia - White males who were living on the 1st day of June, 1880. No others will be included. CHILDREN BORN SINCE

June 1, 1860, will be OMITTED. Masters of Plantations who have DEED SINCE June 1, 1860, will be INCLUDED.
State of Georgia - Dist. No. 14, 15 and 16 and 17 are to be added in respect to negroes under 10 years of age.

SCHEDULE I.—Inhabitants in 1870, Sept. 6, 18, in the County of Lowndes, State of Georgia
(enumerated by me on the 15th day of June, 1880.

Schedule	Name	Sex	Age	Color	Married	Birth	Parents	Marriage	Education
12 50	King, John	M	40	W	1	James	King	1	1
	— William	M	20	W	1	Wm. King	1	1	1
	— George	M	20	W	1	Wm. King	1	1	1
	— Ella	F	30	W	1	Wm. King	1	1	1
	— Lela	F	20	W	1	Wm. King	1	1	1
	— John	M	20	W	1	Wm. King	1	1	1
	— John	M	20	W	1	Wm. King	1	1	1
	— George	M	20	W	1	Wm. King	1	1	1
	— George	M	20	W	1	Wm. King	1	1	1
	— George	M	20	W	1	Wm. King	1	1	1
	— George	M	20	W	1	Wm. King	1	1	1
12 51	King, John	M	40	W	1	James	King	1	1
	— William	M	20	W	1	Wm. King	1	1	1
	— George	M	20	W	1	Wm. King	1	1	1
	— Ella	F	30	W	1	Wm. King	1	1	1
	— Lela	F	20	W	1	Wm. King	1	1	1
	— John	M	20	W	1	Wm. King	1	1	1
	— John	M	20	W	1	Wm. King	1	1	1
	— George	M	20	W	1	Wm. King	1	1	1
	— George	M	20	W	1	Wm. King	1	1	1
	— George	M	20	W	1	Wm. King	1	1	1
12 52	King, John	M	40	W	1	James	King	1	1
	— William	M	20	W	1	Wm. King	1	1	1
	— George	M	20	W	1	Wm. King	1	1	1
	— Ella	F	30	W	1	Wm. King	1	1	1
	— Lela	F	20	W	1	Wm. King	1	1	1
	— John	M	20	W	1	Wm. King	1	1	1
	— John	M	20	W	1	Wm. King	1	1	1
	— George	M	20	W	1	Wm. King	1	1	1
	— George	M	20	W	1	Wm. King	1	1	1
	— George	M	20	W	1	Wm. King	1	1	1
12 53	King, John	M	40	W	1	James	King	1	1
	— William	M	20	W	1	Wm. King	1	1	1
	— George	M	20	W	1	Wm. King	1	1	1
	— Ella	F	30	W	1	Wm. King	1	1	1
	— Lela	F	20	W	1	Wm. King	1	1	1
	— John	M	20	W	1	Wm. King	1	1	1
	— John	M	20	W	1	Wm. King	1	1	1
	— George	M	20	W	1	Wm. King	1	1	1
	— George	M	20	W	1	Wm. King	1	1	1
	— George	M	20	W	1	Wm. King	1	1	1
12 54	King, John	M	40	W	1	James	King	1	1
	— William	M	20	W	1	Wm. King	1	1	1
	— George	M	20	W	1	Wm. King	1	1	1
	— Ella	F	30	W	1	Wm. King	1	1	1
	— Lela	F	20	W	1	Wm. King	1	1	1
	— John	M	20	W	1	Wm. King	1	1	1
	— John	M	20	W	1	Wm. King	1	1	1
	— George	M	20	W	1	Wm. King	1	1	1
	— George	M	20	W					

Atlanta, Fulton County, Georgia

18	670	777	Williams	Adams	57-2	Food	B	M	John	1863	37
	702	789		Jennie	C	Wife	B	F	Phil	1873	27

Atlanta, Fulton County, Georgia

[illegible]

Alberta Christine Williams

- Mother of Martin Luther King, Jr.
- Attended high school at Spelman Seminary in Atlanta
- Enrolled in the Hampton Normal and Industrial Institute in Hampton, Virginia, and received her teaching certificate in March of 1924
- She founded and trained the Ebenezer Baptist Church choir; organized and was president of the Ebenezer Women's Council from 1950 to 1962; and was the organist in the church from 1932 to 1972



1920 Census

Atlanta, Fulton County, Georgia

STATE Georgia COUNTY Fulton TOWNSHIP OR OTHER DIVISION OF COUNTY Atlanta

DEPARTMENT OF COMMERCE—BUREAU OF THE CENSUS
FOURTEENTH CENSUS OF THE UNITED STATES: 1920—POPULATION

NAME OF INCORPORATED PLACE Atlanta CITY
ENumerated by ME ON THE 2nd DAY OF January 1920

SUPERVISOR'S DISTRICT NO. 52nd SHEET NO. 18
ENumerator James A. Johnson

NAME OF INSTITUTION Cathedral School 2nd 18th 1st 2nd 3rd 4th 5th 6th 7th 8th 9th 10th 11th 12th 13th 14th 15th 16th 17th 18th 19th 20th 21st 22nd 23rd 24th 25th 26th 27th 28th 29th 30th 31st 32nd 33rd 34th 35th 36th 37th 38th 39th 40th 41st 42nd 43rd 44th 45th 46th 47th 48th 49th 50th 51st 52nd 53rd 54th 55th 56th 57th 58th 59th 60th 61st 62nd 63rd 64th 65th 66th 67th 68th 69th 70th 71st 72nd 73rd 74th 75th 76th 77th 78th 79th 80th 81st 82nd 83rd 84th 85th 86th 87th 88th 89th 90th 91st 92nd 93rd 94th 95th 96th 97th 98th 99th 100th 101st 102nd 103rd 104th 105th 106th 107th 108th 109th 110th 111th 112th 113th 114th 115th 116th 117th 118th 119th 120th 121st 122nd 123rd 124th 125th 126th 127th 128th 129th 130th 131st 132nd 133rd 134th 135th 136th 137th 138th 139th 140th 141st 142nd 143rd 144th 145th 146th 147th 148th 149th 150th 151st 152nd 153rd 154th 155th 156th 157th 158th 159th 160th 161st 162nd 163rd 164th 165th 166th 167th 168th 169th 170th 171st 172nd 173rd 174th 175th 176th 177th 178th 179th 180th 181st 182nd 183rd 184th 185th 186th 187th 188th 189th 190th 191st 192nd 193rd 194th 195th 196th 197th 198th 199th 200th 201st 202nd 203rd 204th 205th 206th 207th 208th 209th 210th 211st 212nd 213rd 214th 215th 216th 217th 218th 219th 220th 221st 222nd 223rd 224th 225th 226th 227th 228th 229th 230th 231st 232nd 233rd 234th 235th 236th 237th 238th 239th 240th 241st 242nd 243rd 244th 245th 246th 247th 248th 249th 250th 251st 252nd 253rd 254th 255th 256th 257th 258th 259th 260th 261st 262nd 263rd 264th 265th 266th 267th 268th 269th 270th 271st 272nd 273rd 274th 275th 276th 277th 278th 279th 280th 281st 282nd 283rd 284th 285th 286th 287th 288th 289th 290th 291st 292nd 293rd 294th 295th 296th 297th 298th 299th 300th 301st 302nd 303rd 304th 305th 306th 307th 308th 309th 310th 311st 312nd 313rd 314th 315th 316th 317th 318th 319th 320th 321st 322nd 323rd 324th 325th 326th 327th 328th 329th 330th 331st 332nd 333rd 334th 335th 336th 337th 338th 339th 340th 341st 342nd 343rd 344th 345th 346th 347th 348th 349th 350th 351st 352nd 353rd 354th 355th 356th 357th 358th 359th 360th 361st 362nd 363rd 364th 365th 366th 367th 368th 369th 370th 371st 372nd 373rd 374th 375th 376th 377th 378th 379th 380th 381st 382nd 383rd 384th 385th 386th 387th 388th 389th 390th 391st 392nd 393rd 394th 395th 396th 397th 398th 399th 400th 401st 402nd 403rd 404th 405th 406th 407th 408th 409th 410th 411st 412nd 413rd 414th 415th 416th 417th 418th 419th 420th 421st 422nd 423rd 424th 425th 426th 427th 428th 429th 430th 431st 432nd 433rd 434th 435th 436th 437th 438th 439th 440th 441st 442nd 443rd 444th 445th 446th 447th 448th 449th 450th 451st 452nd 453rd 454th 455th 456th 457th 458th 459th 460th 461st 462nd 463rd 464th 465th 466th 467th 468th 469th 470th 471st 472nd 473rd 474th 475th 476th 477th 478th 479th 480th 481st 482nd 483rd 484th 485th 486th 487th 488th 489th 490th 491st 492nd 493rd 494th 495th 496th 497th 498th 499th 500th 501st 502nd 503rd 504th 505th 506th 507th 508th 509th 510th 511st 512nd 513rd 514th 515th 516th 517th 518th 519th 520th 521st 522nd 523rd 524th 525th 526th 527th 528th 529th 530th 531st 532nd 533rd 534th 535th 536th 537th 538th 539th 540th 541st 542nd 543rd 544th 545th 546th 547th 548th 549th 550th 551st 552nd 553rd 554th 555th 556th 557th 558th 559th 560th 561st 562nd 563rd 564th 565th 566th 567th 568th 569th 570th 571st 572nd 573rd 574th 575th 576th 577th 578th 579th 580th 581st 582nd 583rd 584th 585th 586th 587th 588th 589th 590th 591st 592nd 593rd 594th 595th 596th 597th 598th 599th 600th 601st 602nd 603rd 604th 605th 606th 607th 608th 609th 610th 611st 612nd 613rd 614th 615th 616th 617th 618th 619th 620th 621st 622nd 623rd 624th 625th 626th 627th 628th 629th 630th 631st 632nd 633rd 634th 635th 636th 637th 638th 639th 640th 641st 642nd 643rd 644th 645th 646th 647th 648th 649th 650th 651st 652nd 653rd 654th 655th 656th 657th 658th 659th 660th 661st 662nd 663rd 664th 665th 666th 667th 668th 669th 670th 671st 672nd 673rd 674th 675th 676th 677th 678th 679th 680th 681st 682nd 683rd 684th 685th 686th 687th 688th 689th 690th 691st 692nd 693rd 694th 695th 696th 697th 698th 699th 700th 701st 702nd 703rd 704th 705th 706th 707th 708th 709th 710th 711st 712nd 713rd 714th 715th 716th 717th 718th 719th 720th 721st 722nd 723rd 724th 725th 726th 727th 728th 729th 730th 731st 732nd 733rd 734th 735th 736th 737th 738th 739th 740th 741st 742nd 743rd 744th 745th 746th 747th 748th 749th 750th 751st 752nd 753rd 754th 755th 756th 757th 758th 759th 760th 761st 762nd 763rd 764th 765th 766th 767th 768th 769th 770th 771st 772nd 773rd 774th 775th 776th 777th 778th 779th 780th 781st 782nd 783rd 784th 785th 786th 787th 788th 789th 790th 791st 792nd 793rd 794th 795th 796th 797th 798th 799th 800th 801st 802nd 803rd 804th 805th 806th 807th 808th 809th 810th 811st 812nd 813rd 814th 815th 816th 817th 818th 819th 820th 821st 822nd 823rd 824th 825th 826th 827th 828th 829th 830th 831st 832nd 833rd 834th 835th 836th 837th 838th 839th 840th 841st 842nd 843rd 844th 845th 846th 847th 848th 849th 850th 851st 852nd 853rd 854th 855th 856th 857th 858th 859th 860th 861st 862nd 863rd 864th 865th 866th 867th 868th 869th 870th 871st 872nd 873rd 874th 875th 876th 877th 878th 879th 880th 881st 882nd 883rd 884th 885th 886th 887th 888th 889th 890th 891st 892nd 893rd 894th 895th 896th 897th 898th 899th 900th 901st 902nd 903rd 904th 905th 906th 907th 908th 909th 910th 911st 912nd 913rd 914th 915th 916th 917th 918th 919th 920th 921st 922nd 923rd 924th 925th 926th 927th 928th 929th 930th 931st 932nd 933rd 934th 935th 936th 937th 938th 939th 940th 941st 942nd 943rd 944th 945th 946th 947th 948th 949th 950th 951st 952nd 953rd 954th 955th 956th 957th 958th 959th 960th 961st 962nd 963rd 964th 965th 966th 967th 968th 969th 970th 971st 972nd 973rd 974th 975th 976th 977th 978th 979th 980th 981st 982nd 983rd 984th 985th 986th 987th 988th 989th 990th 991st 992nd 993rd 994th 995th 996th 997th 998th 999th 1000th

391 B 16 Williams Adam N head 10 m m B 56 m
— Jennie wife 7 B 45 m
— Alberta daughter 9 B 16 A

Martin Luther King, Jr.'s grandparents, A. D. and Jennie Williams, and their daughter Alberta, lived at 383 Auburn Avenue in Atlanta, Georgia in 1920.

The Parks Family

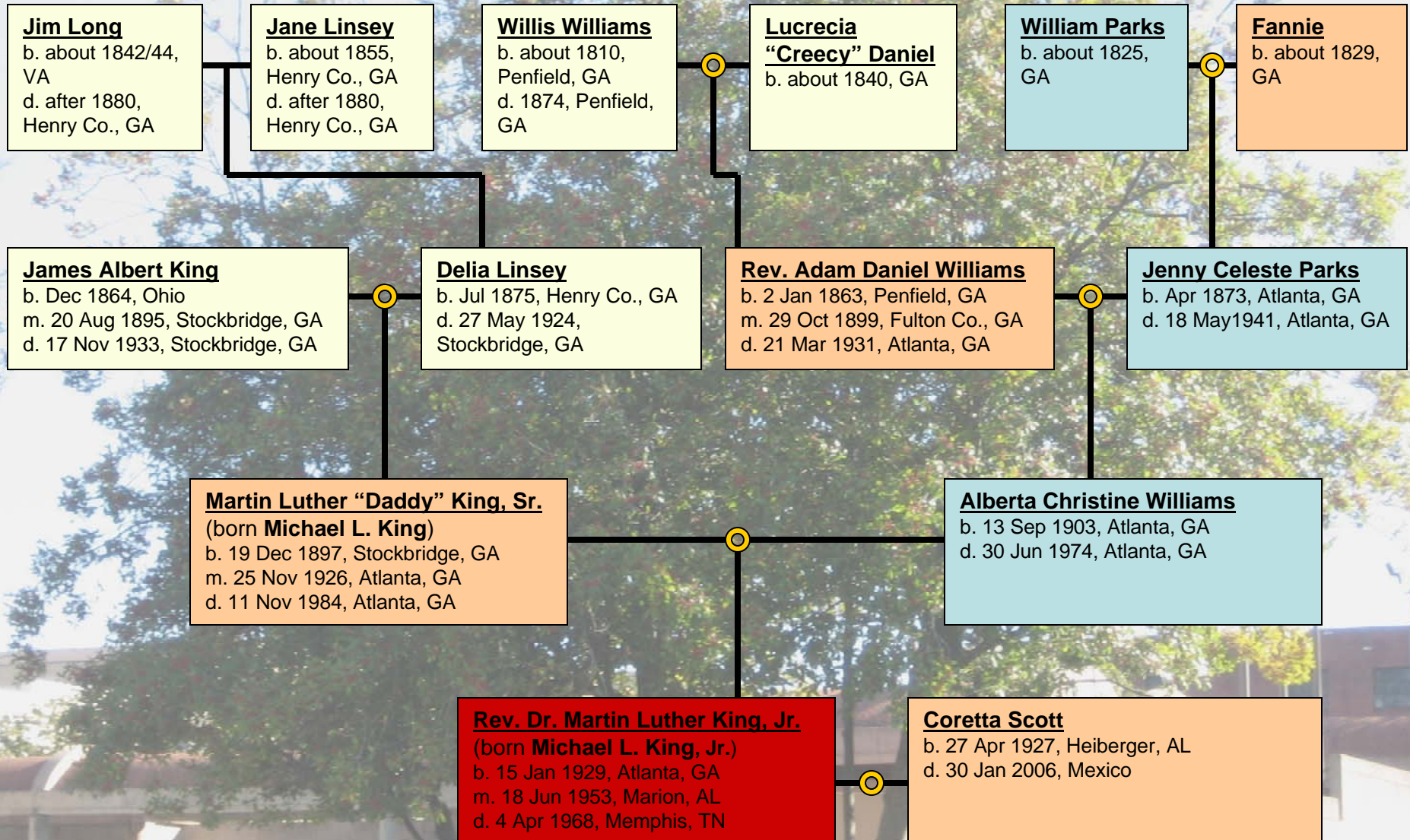

1870 Census

Cross Roads, Cherokee County, Georgia

Page No. 45

SCHEDULE 1.—Inhabitants in Cross Roads 10098 District C. M., in the County of Cherokee, State of Georgia, enumerated by me on the 10th day of June, 1870. Post Office: Ophir. Isaac Ingram, Asst Marshal.

1	2	3	4	5	6	7	8	9	10	11	12	13	14	15	16	17	18	19	20
1	William Henry S	2	M	W					GA										
2	Martha	3	F	W					GA										
3	Nancy M	4	F	W					GA										
4	304 304	5	M	W					GA										
5	Elizabeth	6	F	W					GA										
6	Thomas	7	M	W					GA										
7	Franklin M	8	M	W					GA										
8	Sidney	9	M	W					GA										
9	Elizabeth	10	F	W					GA										
10	Josephine	11	F	W					GA										
11	George	12	M	W					GA										
12	Alfred	13	M	W					GA										
13	Lee	14	M	W					GA										
14	304 304	15	M	W					GA										
15	Sidney E	16	F	W					GA										
16	Margaret A	17	F	W					GA										
17	John M	18	M	W					GA										
18	David W	19	M	W					GA										
19	George W	20	M	W					GA										
20	Nancy M	21	F	W					GA										
21	Mary J	22	F	W					GA										
22	Sidney E	23	M	W					GA										
23	James W	24	M	W					GA										
24	304 304	25	M	W					GA										
25	Catherine G	26	F	W					GA										
26	Benjamin J P	27	M	W					GA										
27	Sarah A E	28	F	W					GA										
28	David J	29	M	W					GA										
29	Mary V	30	F	W					GA										
30	Marianne W	31	F	W					GA										
31	James H	32	M	W					GA										
32	Savannah	33	F	W					GA										
33	304 304	34	M	W					GA										
34	Frances	35	F	W					GA										
35	Catherine A	36	F	W					GA										
36	Mary	37	F	W					GA										
37	Sarah A	38	F	W					GA										
38	William	39	M	W					GA										
39	Rebecca	40	F	W					GA										
40	Harriet		F	W					GA										

Martin Luther King, Jr.'s great-grandparents, William and Frances "Fannie" Parks, were farm laborers in Cross Roads, Cherokee County, Georgia in 1870.

33	304	304	Parks William	45	M	B	Farm labor
34			— Frances	41	F	B	Keeping house
35			— Catherine A	19	F	B	Laborer in farm
36			— Mary	14	F	B	Laborer in farm
37			— Sarah A	12	F	B	Laborer in farm
38			— William	11	M	B	Laborer in farm
39			— Rebecca	9	F	B	
40			— Harriet	7	F	B	

1880 Census

Atlanta, Fulton County, Georgia

Page No. 11
Enumerator's Dist. No. 100
Schedule No. 100

Make A.—The Census Year begins June 1, 1870, and ends May 31, 1880.
Make B.—All persons will be included in the Enumeration who were living on the 1st day of June, 1880. No others will. Children BORN SINCE June 1, 1880, will be OMITTED. Residents of Families who have DEED SINCE June 1, 1880, will be INCLUDED.
Make C.—Quadrants Nos. 10, 14, 18 and 22 are not to be asked to respond to persons under 10 years of age.

SCHEDULE I.—Inhabitants in City of Atlanta, in the County of Fulton, State of Georgia
enumerated by me on the Third day of June, 1880. L. H. Davis

NAME	AGE	SEX	RACE	INDUSTRY	EDUCATION	RELIGION	PROPERTY	VALUE	REMARKS
William Parks	34	M	W	Carpenter	1				
Fanny	22	F	W	Wife	1				
John	18	M	W	Son	1				
George	12	M	W	Son	1				
Harriet	15	F	W	Daughter	1				
Lucie	9	F	W	Daughter	1				
Francis	7	M	W	Daughter	1				
Ira	6	M	W	Daughter	1				

By 1880, the Parks family had moved to Atlanta, where William worked as a carpenter to support his large family.

25	34	W	Parks Wm	34	m	54	1	Carpenter
26	22	F	Fanny	22	f	52	1	Wife
27	18	M	John	18	m	18	1	Son
28	12	M	George	12	m	12	1	Son
29	15	F	Harriet	15	f	15	1	Daughter
30	9	F	Lucie	9	f	9	1	Daughter
31	7	M	Francis	7	m	7	1	Daughter
32	6	F	Ira	6	f	6	1	Daughter

1900 Census

Atlanta, Fulton County, Georgia

TWELFTH CENSUS OF THE UNITED STATES. B

State Georgia County Fulton Supervisor's District No. 5 Sheet No. 23

Township or other division of county Atlanta Name of Institution Atlanta Ward of city G

Enumerated by me on the 16 day of June, 1900. Samuel A. Bond Enumerator. 4203

LOCATIONS	NAME	RELATION	PERSONAL DESCRIPTION		SATISFACTION			CITIZENSHIP	OCCUPATION, TRADE, OR PROFESSION	EDUCATION	NUMBER OF YEARS
			SEX	AGE	Place of birth	Place of birth of father	Place of birth of mother				
1	William	Head	M	35	Georgia	Georgia	Georgia	1	Head	18	35
2	Fannie	Wife	F	35	Georgia	Georgia	Georgia	1	Wife	18	35
3	Sallie	Daughter	F	34	Georgia	Georgia	Georgia	1	Daughter	18	34
4	Charlotte	Daughter	F	25	Georgia	Georgia	Georgia	1	Daughter	18	25

William and Fannie Parks lived on Harris Street in Atlanta in 1900.



61	141	228	589	William	Head	18	35
62				Fannie	Wife	18	35
63				Sallie	Daughter	18	34
64				Charlotte	Daughter	18	25

William and Fannie Parks

- Not much is known about Martin Luther King, Jr.'s Great-Grandparents
- The only information about William and Fannie Parks is what can be gathered from census records

Jennie Celeste Parks

- Jennie was one of 13 children
- Her father was a carpenter in Atlanta
- Jennie was the Grandmother of Martin Luther King, Jr., and was called “Mama” by her family
- She was the president of Ebenezer’s Women’s Missionary Society



- At the age of fifteen, she attended Spelman Seminary in Atlanta

The Linsey Family

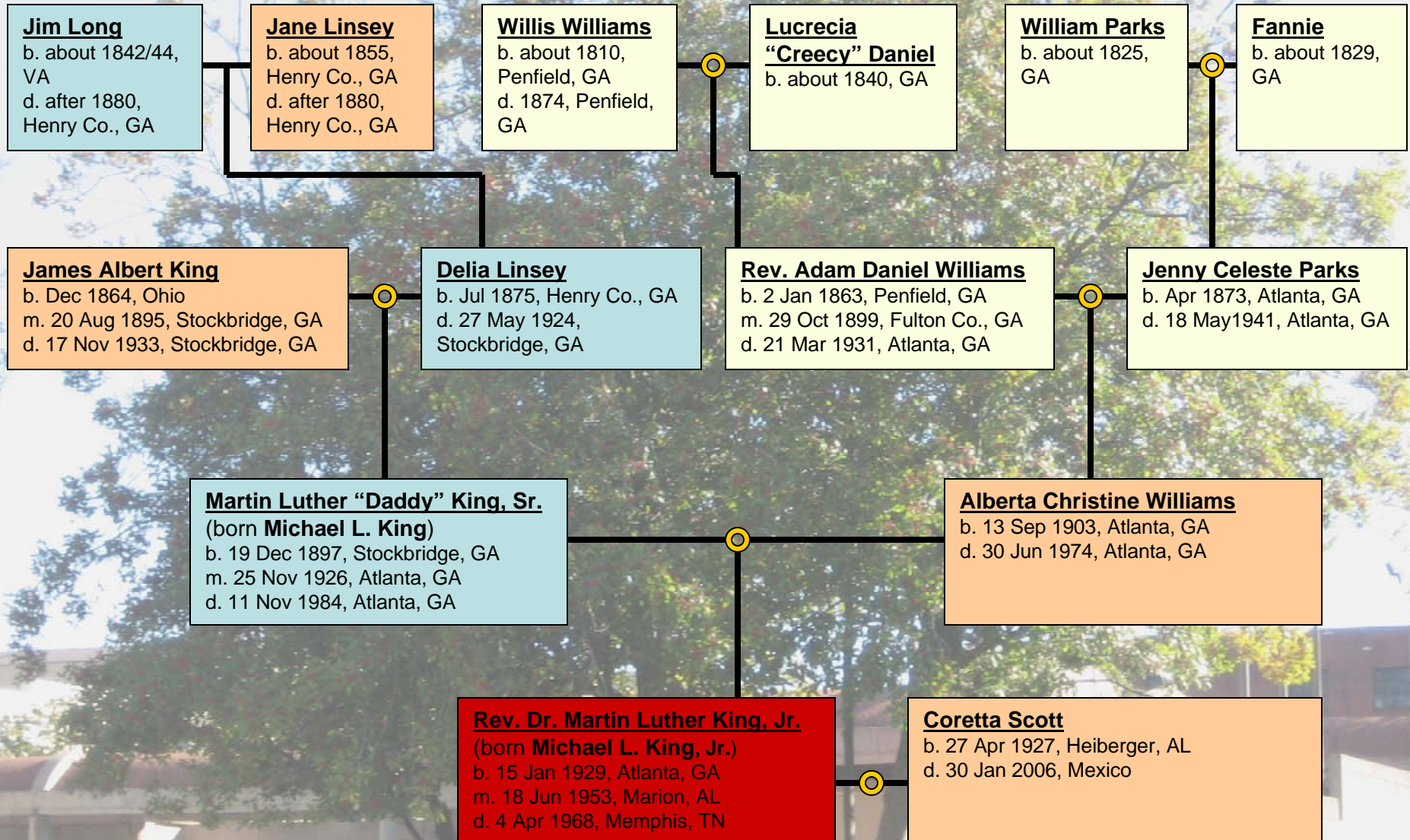

1870 Census

District 611, Henry County, Georgia

Martin Luther King, Jr.'s Great-Grandmother, Jane Linsey, lived in Henry County, Georgia with her son, William, in 1870.

[illegible]

1880 Census

District 611, Henry County, Georgia

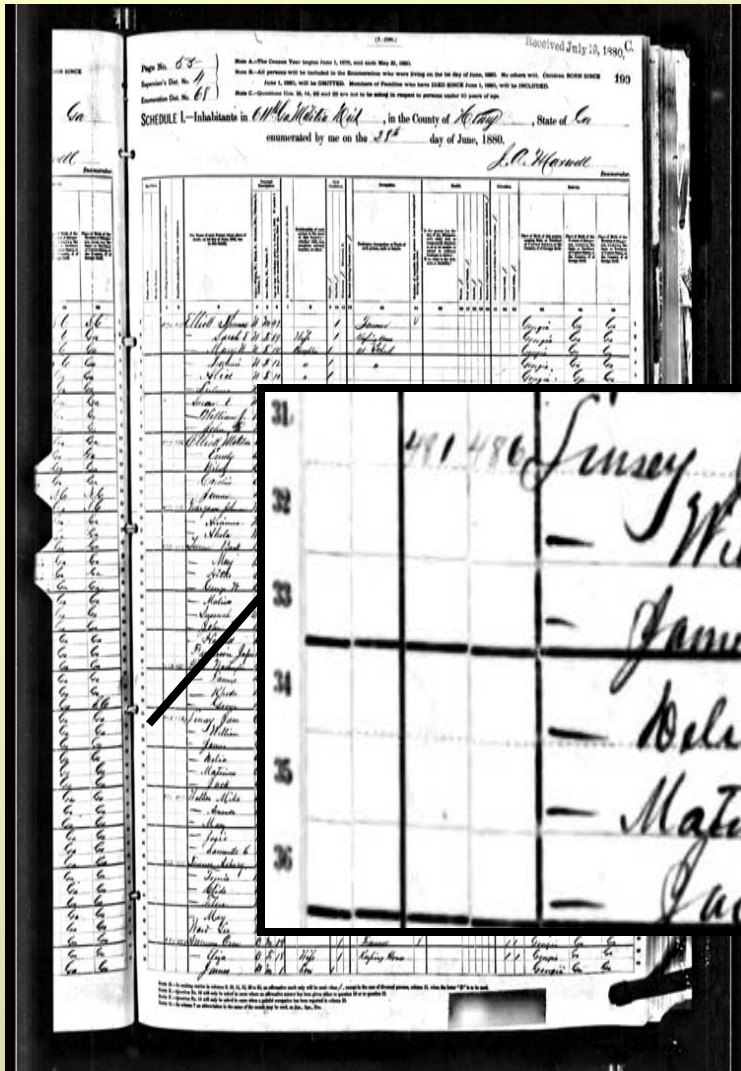

Jane Linsey lived in Henry County, Georgia in 1880 with her five children. Delia Linsey was only five years old.

491486	Linsey Jane	B	F	27					1	Keeping House
	- William	B	M	11					1	
	- James	B	M	8					1	
	- Delia	B	F	5					1	daughter
	- Matmon	B	M	3					1	Son
	- Jack	B	M	2					1	Son

Jim Long and Jane Linsey

- Not much is known about Martin Luther King, Jr.'s Great-Grandparents
- The only information about Jim Long and Jane Linsey is what can be gathered from census records

Delia Linsey

- Grandmother of Martin Luther King, Jr.
- Her father, Jim Long, was a former slave
- She had nine children with her husband, James King
- She attended Floyd Chapel Baptist Church in Stockbridge, Georgia with her children

Ellenwood, Clayton County, Georgia

By 1900, Jane Linsey and six of her children lived together in Ellenwood, Georgia. Delia Linsey was married to James King by this time and also lived in Ellenwood.

289293	Linsey, James	7/7	1880	B F	1881	1885	2nd
	—, Jim		Son	B	m	1874	25 S
	—, Hattie		Daughter	B	F	March 1879	21 S
	—, Florence		Daughter	B	F	April 1882	18 S
	—, Mary		Daughter	B	F	Sept 1886	13 S
	—, Agnes		Daughter	B	F	Dec 1890	7 S
	—, Louis		Son	B	m	May 1899	1 S

The King Family

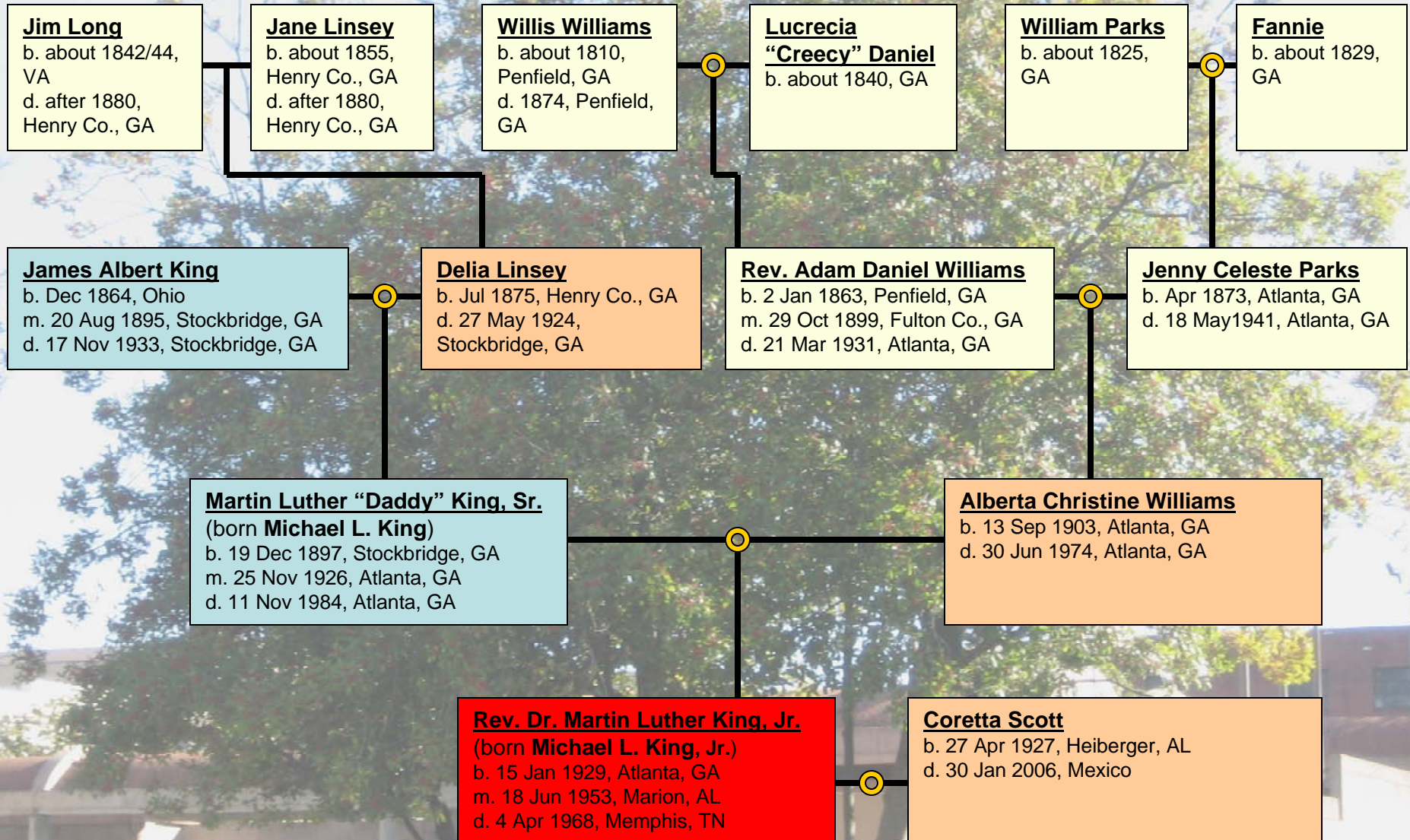

1900 Census

Ellenwood, Clayton County, Georgia

1-284
TWELFTH CENSUS OF THE UNITED STATES. B

State Georgia SCHEDULE No. 1.—POPULATION. (Supervisor's District No. 6) Sheet No. 80
County Clayton (Enumeration District No. 16)

Township or other division of county Ellenwood Precinct Name of Institution X Ward of city X
Name of incorporated city, town, or village, within the above-named division X
Examined by me on the 23 day of June, 1900. Francis M. Smith Enumerator. 2607

LOCATOR	NAME	RELATION	PERSONAL DESCRIPTION	SEX	AGE	BIRTH	NATIVITY	CITIZENSHIP	OCCUPATION, TRADE, OR SERVICE	EDUCATION	MARRIED	SINGLE
3474	Anderson, John	Head	W. M.	30	1870	Georgia	Georgia	30	Farmer	8	Married	1
3475	Anderson, Mary	Wife	W. F.	28	1872	Georgia	Georgia	28	Housewife	8	Married	1
3476	Anderson, James	Son	W. M.	10	1889	Georgia	Georgia	10	School teacher	8	Married	1
3477	Anderson, Mary	Daughter	W. F.	8	1891	Georgia	Georgia	8	School teacher	8	Married	1
3478	Anderson, John	Son	W. M.	6	1893	Georgia	Georgia	6	School teacher	8	Married	1
3479	Anderson, Mary	Daughter	W. F.	4	1895	Georgia	Georgia	4	School teacher	8	Married	1
3480	Anderson, John	Son	W. M.	2	1897	Georgia	Georgia	2	School teacher	8	Married	1
3481	Anderson, Mary	Daughter	W. F.	1	1898	Georgia	Georgia	1	School teacher	8	Married	1
3482	Anderson, John	Son	W. M.	11	1889	Georgia	Georgia	11	School teacher	8	Married	1
3483	Anderson, Mary	Daughter	W. F.	9	1891	Georgia	Georgia	9	School teacher	8	Married	1
3484	Anderson, John	Son	W. M.	7	1893	Georgia	Georgia	7	School teacher	8	Married	1
3485	Anderson, Mary	Daughter	W. F.	5	1895	Georgia	Georgia	5	School teacher	8	Married	1
3486	Anderson, John	Son	W. M.	3	1897	Georgia	Georgia	3	School teacher	8	Married	1
3487	Anderson, Mary	Daughter	W. F.	1	1898	Georgia	Georgia	1	School teacher	8	Married	1
3488	Anderson, John	Son	W. M.	12	1888	Georgia	Georgia	12	School teacher	8	Married	1
3489	Anderson, Mary	Daughter	W. F.	10	1890	Georgia	Georgia	10	School teacher	8	Married	1
3490	Anderson, John	Son	W. M.	8	1892	Georgia	Georgia	8	School teacher	8	Married	1
3491	Anderson, Mary	Daughter	W. F.	6	1894	Georgia	Georgia	6	School teacher	8	Married	1
3492	Anderson, John	Son	W. M.	4	1896	Georgia	Georgia	4	School teacher	8	Married	1
3493	Anderson, Mary	Daughter	W. F.	2	1898	Georgia	Georgia	2	School teacher	8	Married	1
3494	Anderson, John	Son	W. M.	1	1899	Georgia	Georgia	1	School teacher	8	Married	1
3495	Anderson, Mary	Daughter	W. F.	13	1887	Georgia	Georgia	13	School teacher	8	Married	1
3496	Anderson, John	Son	W. M.	11	1889	Georgia	Georgia	11	School teacher	8	Married	1
3497	Anderson, Mary	Daughter	W. F.	9	1891	Georgia	Georgia	9	School teacher	8	Married	1
3498	Anderson, John	Son	W. M.	7	1893	Georgia	Georgia	7	School teacher	8	Married	1
3499	Anderson, Mary	Daughter	W. F.	5	1895	Georgia	Georgia	5	School teacher	8	Married	1
3500	Anderson, John	Son	W. M.	3	1897	Georgia	Georgia	3	School teacher	8	Married	1
3501	Anderson, Mary	Daughter	W. F.	1	1898	Georgia	Georgia	1	School teacher	8	Married	1
3502	Anderson, John	Son	W. M.	14	1886	Georgia	Georgia	14	School teacher	8	Married	1
3503	Anderson, Mary	Daughter	W. F.	12	1888	Georgia	Georgia	12	School teacher	8	Married	1
3504	Anderson, John	Son	W. M.	10	1890	Georgia	Georgia	10	School teacher	8	Married	1
3505	Anderson, Mary	Daughter	W. F.	8	1892	Georgia	Georgia	8	School teacher	8	Married	1
3506	Anderson, John	Son	W. M.	6	1894	Georgia	Georgia	6	School teacher	8	Married	1
3507	Anderson, Mary	Daughter	W. F.	4	1896	Georgia	Georgia	4	School teacher	8	Married	1
3508	Anderson, John	Son	W. M.	2	1898	Georgia	Georgia	2	School teacher	8	Married	1
3509	Anderson, Mary	Daughter	W. F.	15	1885	Georgia	Georgia	15	School teacher	8	Married	1
3510	Anderson, John	Son	W. M.	13	1887	Georgia	Georgia	13	School teacher	8	Married	1
3511	Anderson, Mary	Daughter	W. F.	11	1889	Georgia	Georgia	11	School teacher	8	Married	1
3512	Anderson, John	Son	W. M.	9	1891	Georgia	Georgia	9	School teacher	8	Married	1
3513	Anderson, Mary	Daughter	W. F.	7	1893	Georgia	Georgia	7	School teacher	8	Married	1
3514	Anderson, John	Son	W. M.	5	1895	Georgia	Georgia	5	School teacher	8	Married	1
3515	Anderson, Mary	Daughter	W. F.	3	1897	Georgia	Georgia	3	School teacher	8	Married	1
3516	Anderson, John	Son	W. M.	1	1898	Georgia	Georgia	1	School teacher	8	Married	1
3517	Anderson, Mary	Daughter	W. F.	16	1884	Georgia	Georgia	16	School teacher	8	Married	1
3518	Anderson, John	Son	W. M.	14	1886	Georgia	Georgia	14	School teacher	8	Married	1
3519	Anderson, Mary	Daughter	W. F.	12	1888	Georgia	Georgia	12	School teacher	8	Married	1
3520	Anderson, John	Son	W. M.	10	1890	Georgia	Georgia	10	School teacher	8	Married	1
3521	Anderson, Mary	Daughter	W. F.	8	1892	Georgia	Georgia	8	School teacher	8	Married	1
3522	Anderson, John	Son	W. M.	6	1894	Georgia	Georgia	6	School teacher	8	Married	1
3523	Anderson, Mary	Daughter	W. F.	4	1896	Georgia	Georgia	4	School teacher	8	Married	1
3524	Anderson, John	Son	W. M.	2	1898	Georgia	Georgia	2	School teacher	8	Married	1
3525	Anderson, Mary	Daughter	W. F.	17	1883	Georgia	Georgia	17	School teacher	8	Married	1
3526	Anderson, John	Son	W. M.	15	1885	Georgia	Georgia	15	School teacher	8	Married	1
3527	Anderson, Mary	Daughter	W. F.	13	1887	Georgia	Georgia	13	School teacher	8	Married	1
3528	Anderson, John	Son	W. M.	11	1889	Georgia	Georgia	11	School teacher	8	Married	1
3529	Anderson, Mary	Daughter	W. F.	9	1891	Georgia	Georgia	9	School teacher	8	Married	1
3530	Anderson, John	Son	W. M.	7	1893	Georgia	Georgia	7	School teacher	8	Married	1
3531	Anderson, Mary	Daughter	W. F.	5	1895	Georgia	Georgia	5	School teacher	8	Married	1
3532	Anderson, John	Son	W. M.	3	1897	Georgia	Georgia	3	School teacher	8	Married	1
3533	Anderson, Mary	Daughter	W. F.	1	1898	Georgia	Georgia	1	School teacher	8	Married	1
3534	Anderson, John	Son	W. M.	18	1882	Georgia	Georgia	18	School teacher	8	Married	1
3535	Anderson, Mary	Daughter	W. F.	16	1884	Georgia	Georgia	16	School teacher	8	Married	1
3536	Anderson, John	Son	W. M.	14	1886	Georgia	Georgia	14	School teacher	8	Married	1
3537	Anderson, Mary	Daughter	W. F.	12	1888	Georgia	Georgia	12	School teacher	8	Married	1
3538	Anderson, John	Son	W. M.	10	1890	Georgia	Georgia	10	School teacher	8	Married	1
3539	Anderson, Mary	Daughter	W. F.	8	1892	Georgia	Georgia	8	School teacher	8	Married	1
3540	Anderson, John	Son	W. M.	6	1894	Georgia	Georgia	6	School teacher	8	Married	1
3541	Anderson, Mary	Daughter	W. F.	4	1896	Georgia	Georgia	4	School teacher	8	Married	1
3542	Anderson, John	Son	W. M.	2	1898	Georgia	Georgia	2	School teacher	8	Married	1
3543	Anderson, Mary	Daughter	W. F.	19	1881	Georgia	Georgia	19	School teacher	8	Married	1
3544	Anderson, John	Son	W. M.	17	1883	Georgia	Georgia	17	School teacher	8	Married	1
3545	Anderson, Mary	Daughter	W. F.	15	1885	Georgia	Georgia	15	School teacher	8	Married	1
3546	Anderson, John	Son	W. M.	13	1887	Georgia	Georgia	13	School teacher	8	Married	1
3547	Anderson, Mary	Daughter	W. F.	11	1889	Georgia	Georgia	11	School teacher	8	Married	1
3548	Anderson, John	Son	W. M.	9	1891	Georgia	Georgia	9	School teacher	8	Married	1
3549	Anderson, Mary	Daughter	W. F.	7	1893	Georgia	Georgia	7	School teacher	8	Married	1
3550	Anderson, John	Son	W. M.	5	1895	Georgia	Georgia	5	School teacher	8	Married	1
3551	Anderson, Mary	Daughter	W. F.	3	1897	Georgia	Georgia	3	School teacher	8	Married	1
3552	Anderson, John	Son	W. M.	1	1898	Georgia	Georgia	1	School teacher	8	Married	1
3553	Anderson, Mary	Daughter	W. F.	20	1880	Georgia	Georgia	20	School teacher	8	Married	1
3554	Anderson, John	Son	W. M.	18	1882	Georgia	Georgia	18	School teacher	8	Married	1
3555	Anderson, Mary	Daughter	W. F.	16	1884	Georgia	Georgia	16	School teacher	8	Married	1
3556	Anderson, John	Son	W. M.	14	1886	Georgia	Georgia	14	School teacher	8	Married	1
3557	Anderson, Mary	Daughter	W. F.	12	1888	Georgia	Georgia	12	School teacher	8	Married	1
3558	Anderson, John	Son	W. M.	10	1890	Georgia	Georgia	10	School teacher	8	Married	1
3559	Anderson, Mary	Daughter	W. F.	8	1892	Georgia	Georgia	8	School teacher	8	Married	1
3560	Anderson, John	Son	W. M.	6	1894	Georgia	Georgia	6	School teacher	8	Married	1
3561	Anderson, Mary	Daughter	W. F.	4	1896	Georgia	Georgia	4	School teacher	8	Married	1
3562	Anderson, John	Son	W. M.	2	1898	Georgia	Georgia	2	School teacher	8	Married	1
3563	Anderson, Mary	Daughter	W. F.	21	1879	Georgia	Georgia	21	School teacher	8	Married	1
3564	Anderson, John	Son	W. M.	19	1881	Georgia	Georgia	19	School teacher	8	Married	1
3565	Anderson, Mary	Daughter	W. F.	17	1883	Georgia	Georgia	17	School teacher	8	Married	1
3566	Anderson, John	Son	W. M.	15	1885	Georgia	Georgia	15	School teacher	8	Married	1
3567	Anderson, Mary	Daughter	W. F.	13	1887	Georgia	Georgia	13	School teacher	8	Married	1
3568	Anderson, John	Son	W. M.	11	1889	Georgia	Georgia	11	School teacher	8	Married	1
3569	Anderson, Mary	Daughter	W. F.	9	1891	Georgia	Georgia	9	School teacher	8	Married	1
3570	Anderson, John	Son	W. M.	7	1893	Georgia	Georgia	7	School teacher	8	Married	1
3571	Anderson, Mary	Daughter	W. F.	5	1895	Georgia	Georgia	5	School teacher	8	Married	1
3572	Anderson, John	Son	W. M.	3	1897	Georgia	Georgia	3	School teacher	8	Married	1
3573	Anderson, Mary	Daughter	W. F.	1	1898	Georgia	Georgia	1	School teacher	8	Married	1
3574	Anderson, John	Son	W. M.	22	1878	Georgia	Georgia	22	School teacher	8	Married	1
3575	Anderson, Mary	Daughter	W. F.	20	1880	Georgia	Georgia	20	School teacher	8	Married	1
3576	Anderson, John	Son	W. M.	18	1882	Georgia	Georgia	18	School teacher	8	Married	1
3577	Anderson, Mary	Daughter	W. F.	16	1884	Georgia	Georgia	16	School teacher	8	Married	1
3578	Anderson, John	Son	W. M.	14	1886	Georgia	Georgia	14	School teacher	8	Married	1
3579	Anderson, Mary	Daughter	W. F.	12	1888	Georgia	Georgia	12	School teacher	8	Married	1
3580	Anderson, John</											

1910 Census

Stockbridge, Henry County, Georgia

[illegible]

The King family lived at Jonesboro and Covington Road in Stockbridge in Henry County, Georgia. By 1910, James and Delia King had seven children.

James Albert King

- Grandfather of Martin Luther King, Jr.
- James and his wife, Delia, were sharecroppers
- He worked at the rock quarry in Stockbridge for a while
- He and his family moved throughout Henry and Clayton Counties until they finally settled in Stockbridge, Georgia

Where the King Family Lived and Worked in Henry County

On February 12, 1970, an article was published in a Henry County newspaper, The *Weekly-Advertiser*, that talked about the King family working on farmland in Stockbridge in Henry County, Georgia. The land was owned by Rosa Lee Smith, who owned large landholdings in Henry County. On this map, the green shaded areas are where Rosa Lee Smith's farmland was located in Stockbridge.

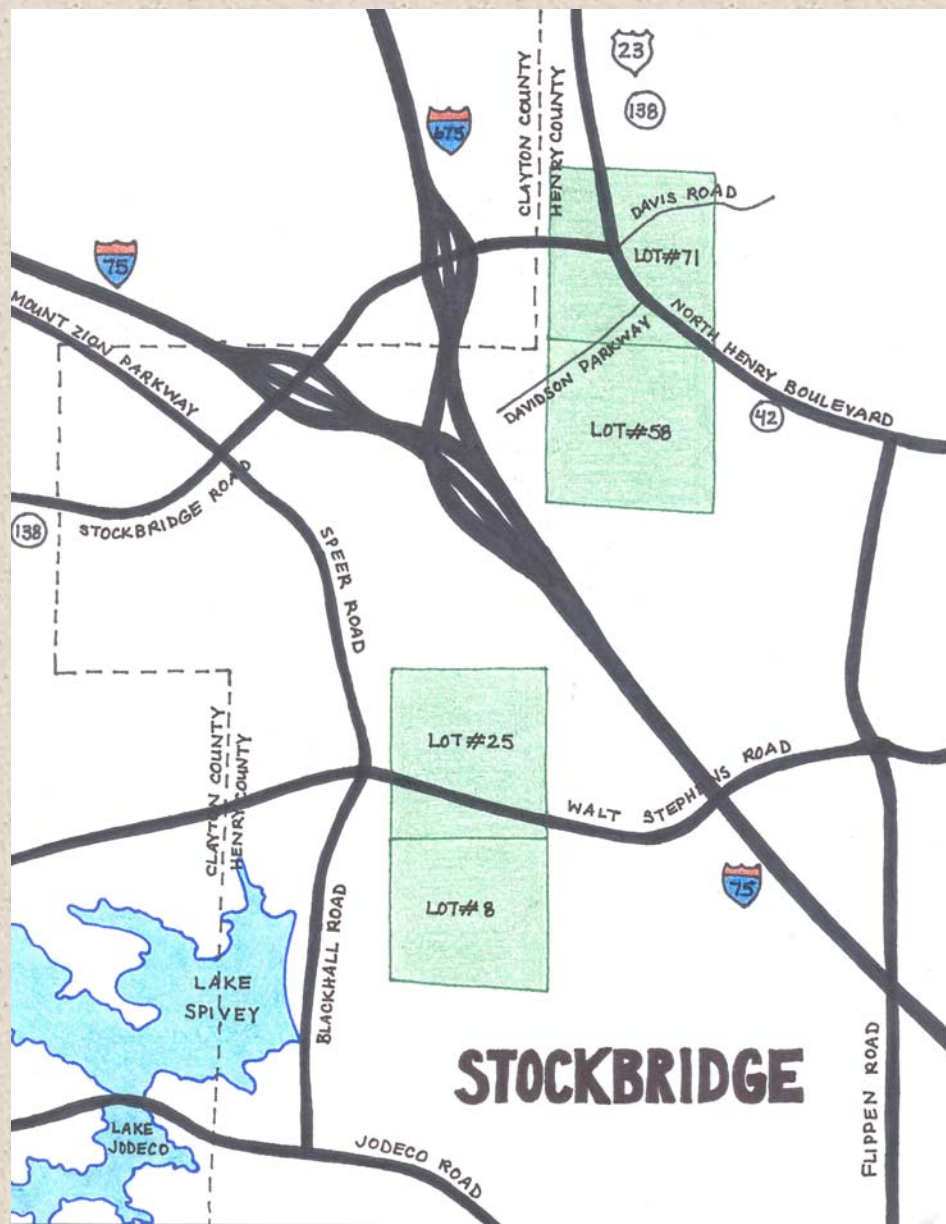

Martin Luther “Daddy” King, Sr.

- He was born Michael L. King, but he changed both his and his son’s names later to Martin Luther King; he was also known by many as “Daddy King”
- He was the son of sharecroppers and became a country preacher when he grew older
- Michael received his degree from Morehouse College in 1930
- Martin, Sr. became the minister of Ebenezer Baptist Church after the death of his father-in-law in 1931
- Martin Luther King, Sr. resigned from Ebenezer Baptist Church after the death of his wife, Alberta, in 1974



World War I Draft Registration Card for Michael King

Martin Luther King, Jr.'s father (born Michael King) registered for the draft in Stockbridge, Henry County, Georgia on 12 September 1918. He was 18 years old and listed his mother as his nearest relative.

REGISTRATION CARD				
SERIAL NUMBER	1106		ORDER NUMBER	21374
1	Michael		King	
	(First name)	(Middle name)	(Last name)	
2	PERMANENT HOME ADDRESS:			
	Stockbridge Ga			
	(No.)	(Street or R. F. D. No.)	(City or town)	(County) (State)
Age in Years	Date of Birth			
3	18	4	Dec	19 1899
		(Month.)	(Day.)	(Year.)
RACE				
White		Negro	Oriental	Indian
5		6 Yes	7	8 Citizen Noncitizen
				2
U. S. CITIZEN			ALIEN	
Native Born		Naturalized	Citizen by Father's Naturalization Before Registrant's Majority	Declarant Non-declarant
10	yes	11	12	13 14
15	If not a citizen of the U. S., of what nation are you a citizen or subject?			
PRESENT OCCUPATION			EMPLOYER'S NAME	
16	Farming		P. F. Ellison	
18	PLACE OF EMPLOYMENT OR BUSINESS:			
	Stockbridge Ga			
	(No.)	(Street or R. F. D. No.)	(City or town)	(County) (State)
NEAREST RELATIVE	Name	19 Delia King		
	Address	20 Stockbridge Ga		
		(No.)	(Street or R. F. D. No.)	(City or town) (County) (State)
I AFFIRM THAT I HAVE VERIFIED ABOVE ANSWERS AND THAT THEY ARE TRUE				
P. M. G. O. Form No. 1 (Red)				
Michael King				(OVER)

[illegible]

1930 Census

Atlanta, Fulton County, Georgia

[illegible]

In 1930, Martin Luther King, Jr. lived with his parents, Martin Luther, Sr. and Alberta, his Great Aunt Ida, and his cousin Joel at 501 Auburn Avenue in Atlanta. This was the house he and his siblings were born in and also where they grew up.

501 Auburn Avenue



This was the house that the King family lived in on the 1930 Census, as well as the birth home of Martin Luther King, Jr. and his two siblings.



Rev. Dr. Martin Luther King, Jr.

- Graduate of Morehouse College, class of 1948
- He was a leader of the Civil Rights Movement in the United States
- He was a minister at Ebenezer Baptist Church in Atlanta with his father
- Martin Luther King, Jr. was assassinated on 4 April 1968 in Memphis, Tennessee



Draft Registration Card for Martin Luther King, Jr.,

23 January 1947

GA #173

FORM APPROVED
Budget Bureau No. 33-R012-42

REGISTRATION CARD (Men born on or after July 1, 1924, and on or before December 31, 1924)
(Also for the registration of men as they reach the 18th anniversary of the date of their birth on or after January 1, 1943.)

SERIAL NUMBER **W 898A** 1. Name (Print) **Martin Luther King, Jr.** ORDER NUMBER **14149A**

2. PLACE OF RESIDENCE (Print) **193 Blvd. N.E. Atlanta, Ga.**

(Number and street) (Town, township, village, or city) (County) (State)

[THE PLACE OF RESIDENCE GIVEN ON LINE 2 ABOVE WILL DETERMINE LOCAL BOARD JURISDICTION; LINE 2 OF REGISTRATION CERTIFICATE WILL BE IDENTICAL]

3. MAILING ADDRESS **Same**

(Mailing address if other than place indicated on line 2. If same, insert word same)

4. TELEPHONE **Wa 5861** 5. AGE IN YEARS **18** 6. PLACE OF BIRTH **Atlanta, Georgia**

(Exchange) (Number) (Mo.) (Day) (Yr.) (Town or county) (State or country)

7. NAME AND ADDRESS OF PERSON WHO WILL ALWAYS KNOW YOUR ADDRESS **Mr. + Mrs. M. L. King, Jr. (Parents) Same address.**

8. EMPLOYEE'S NAME AND ADDRESS

9. PLACE OF EMPLOYMENT OR BUSINESS **Morehouse College**

(Number and street or R. F. D. number) (Town) (County) (State)

I AFFIRM THAT I HAVE VERIFIED ABOVE ANSWERS AND THAT THEY ARE TRUE.

DSS Form 1 (Rev. 11-16-42) 16-21630-4 (OVER) **Martin L. King Jr.**

(Registrant's signature)

Martin Luther King, Jr. registered for the draft on 23 January 1947 in Atlanta, Georgia. He was a student at Morehouse College and lived with his parents at 193 Boulevard.

REGISTRAR'S REPORT

DESCRIPTION OF REGISTRANT

RACE	HEIGHT (Approx.)	WEIGHT (Approx.)	COMPLEXION
White	5'7"	149 lbs	Sallow
Negro	<input checked="" type="checkbox"/>	<input checked="" type="checkbox"/>	Light
Indian	Blue	Blonde	Ruddy
Filipino	Gray	Red	Dark
Japanese	Hazel	Brown	Freckled
Other Oriental	Brown	Black	Light brown
	Black	Gray	Dark brown
		Bald	Black

Other obvious physical characteristics that will aid in identification

I certify that my answers are true; that the person registered has read or has had read to him his own answers; that I have witnessed his signature or mark and that all of his answers of which I have knowledge are true, except as follows:

Did not register because of being a member of college. Margaret J. Kelly

Registrar for Local Board **11** **Atlanta, Ga.**

Date of registration **1-23-47**

(The stamp of the Local Board having jurisdiction of the registrant shall be placed in the above space)

U. S. GOVERNMENT PRINTING OFFICE 16-21630-1

Sources and Further Reading

- Carson, Clayborne, ed. *The Autobiography of Martin Luther King, Jr.* New York: Grand Central Publishing, 1998.
- Carson, Clayborne, ed. *The Papers of Martin Luther King, Jr., Volume 1: Called to Serve, January 1929-June 1951.* Los Angeles: University of California Press, 1992.
- Draft Registration Card for Martin Luther King, Jr.; Records of the Selective Service System, 1940-, Record Group 147; National Archives and Records Administration - Southeast Region (Atlanta).
- Draft Registration Card for Michael King; Records of the Selective Service System (World War I), Record Group 163; National Archives and Records Administration - Southeast Region (Atlanta).
- Farris, Christine King. *Through It All: Reflections on My Life, My Family, and My Faith.* New York: Atria Books, 2009.
- *Martin Luther King, Jr.*; "Portraits of Outstanding Americans of Negro Origin Painted by Two Women Artists"; Collection H: Harmon Foundation Collection, 1922 - 1967; Still Picture Records Section, Special Media Archives Services Division (NWCS-S), National Archives at College Park, MD. [Online version on April 13, 2009, available through the online catalog at <http://www.archives.gov/research/arc/>].
- The Martin Luther King, Jr. Research and Education Institute. King Online Encyclopedia. Stanford University, Stanford, California. http://mlk-kpp01.stanford.edu/index.php/resources/article/king_online_encyclopedia1/.
- Morehouse College Web Site. Morehouse College, Atlanta, Georgia. <http://www.morehouse.edu/>.
- Morehouse King Collection. Morehouse College, Atlanta, Georgia. <http://www.morehouse.edu/kingcollection/background.html>.
- NAACP Web Site. National Association for the Advancement of Colored People. <http://www.naACP.org/>.

Sources and Further Reading

- Photographs of Randolph Street, Harris Street, Boulevard, Auburn Avenue, Ebenezer Baptist Church, Morehouse College, Spelman College, and the tree background on Slides 2, 3, 14, 20, and 26, courtesy of Ashley Judy.
- Rainer, Vessie Thrasher. *Henry County, Georgia: Landmark Houses*. McDonough, Georgia: Vessie Thrasher Rainer, 1986.
- Rainer, Vessie Thrasher. *Henry County, Georgia: The Mother of All Counties*. McDonough, Georgia: Vessie Thrasher Rainer, 1971.
- “Sharecropping.” The New Georgia Encyclopedia. Georgia Humanities Council and the University of Georgia Press.
<http://www.georgiaencyclopedia.org/nge/Article.jsp?path=/HistoryArchaeology/CivilWarandReconstruction/Topics-12&id=h-3590>.
- Spelman College Web Site. Spelman College, Atlanta, Georgia. <http://www.spelman.edu/>.
- Stockbridge Map on Slide 30, drawn by Ashley Judy.
- Turner, Freda Reid. *Henry County, Georgia, 1821-1894: Marriage, Colored/Freedmen Records of Sales Inventory and Wills*. McDonough, Georgia: Freda Reid Turner, 1995.
- *Tuskegee 1894?*, Tuskegee Syphilis Study Administrative Records; Department of Health, Education, and Welfare. Public Health Service. Health Services and Mental Health Administration. Center for Disease Control. Venereal Disease Branch (1970 - 1973); Records of the Centers for Disease Control and Prevention, Record Group 442; National Archives and Records Administration – Southeast Region (Atlanta).
- United States Federal Census Records, 1860-1930; Records of the Bureau of the Census, Record Group 29; National Archives and Records Administration – Southeast Region (Atlanta).